

Compact Size Absolute Water Level Meter

S&DL mini

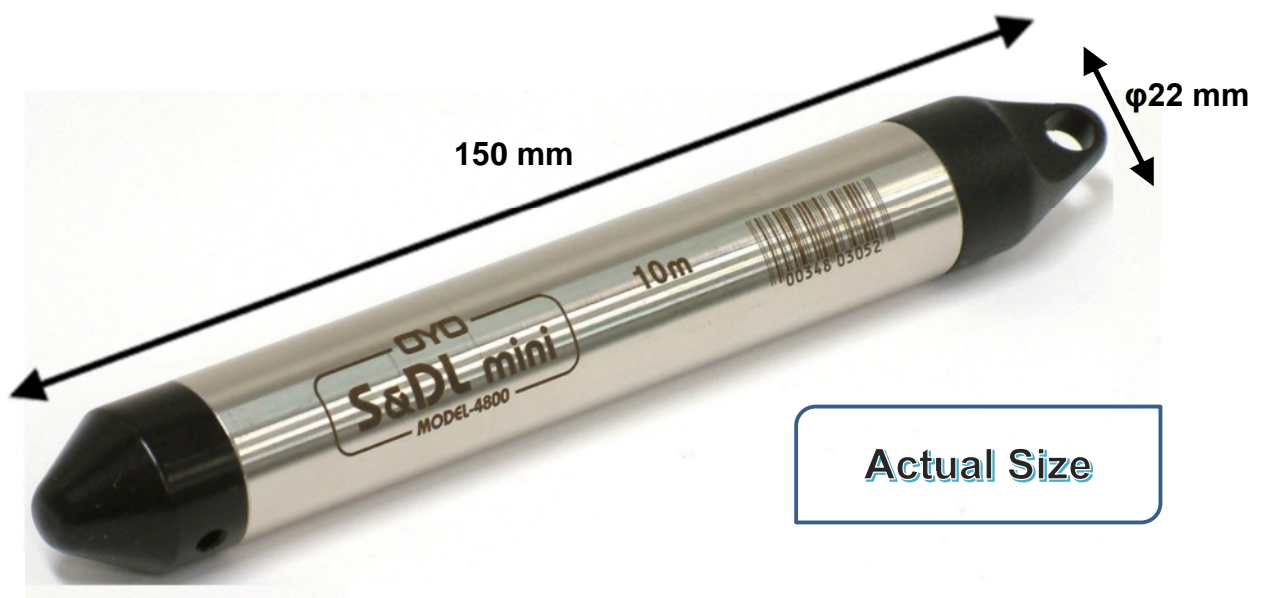

<Abstract>

S&DL min is a water level gauge with reasonable cost. It contains a data logger, battery, pressure transducer and temperature sensor, all housed in a very small stainless steel housing.

No vented cable or desiccants are needed. S&DL mini Barometer is available to provide the most accurate and easy method of barometric compensation.

<Feature>

- **Compact Size**
φ22 × (L) 150 mm
- **Several Ranges**
5, 10, 20, 30, and 100 m are available
- **Large Memory**
40,000 records
- **High Reliability**

<Specification>

Level Sensor

Range : 5, 10, 20, 30, and 100 m + Barometer
 Accuracy : ± 0.1 % FS
 Resolution : 0.1, 0.3, 0.6, 0.9, and 3.0 cm

Temperature Sensor

Range : -20 to +50 °C
 Accuracy : ± 0.3 °C
 Resolution : 0.1 °C

Others

Operating Temperature : 0 to +40 °C
 Dimensions : $\phi 22$ x (L) 150 mm
 Memory : 40,000 Readings of Level and Temperature
 Battery Life : Up to 8 Years (Measurement with 10 mins interval)
 Logging Rates : 0.5 sec to 99 hours

<Configuration>

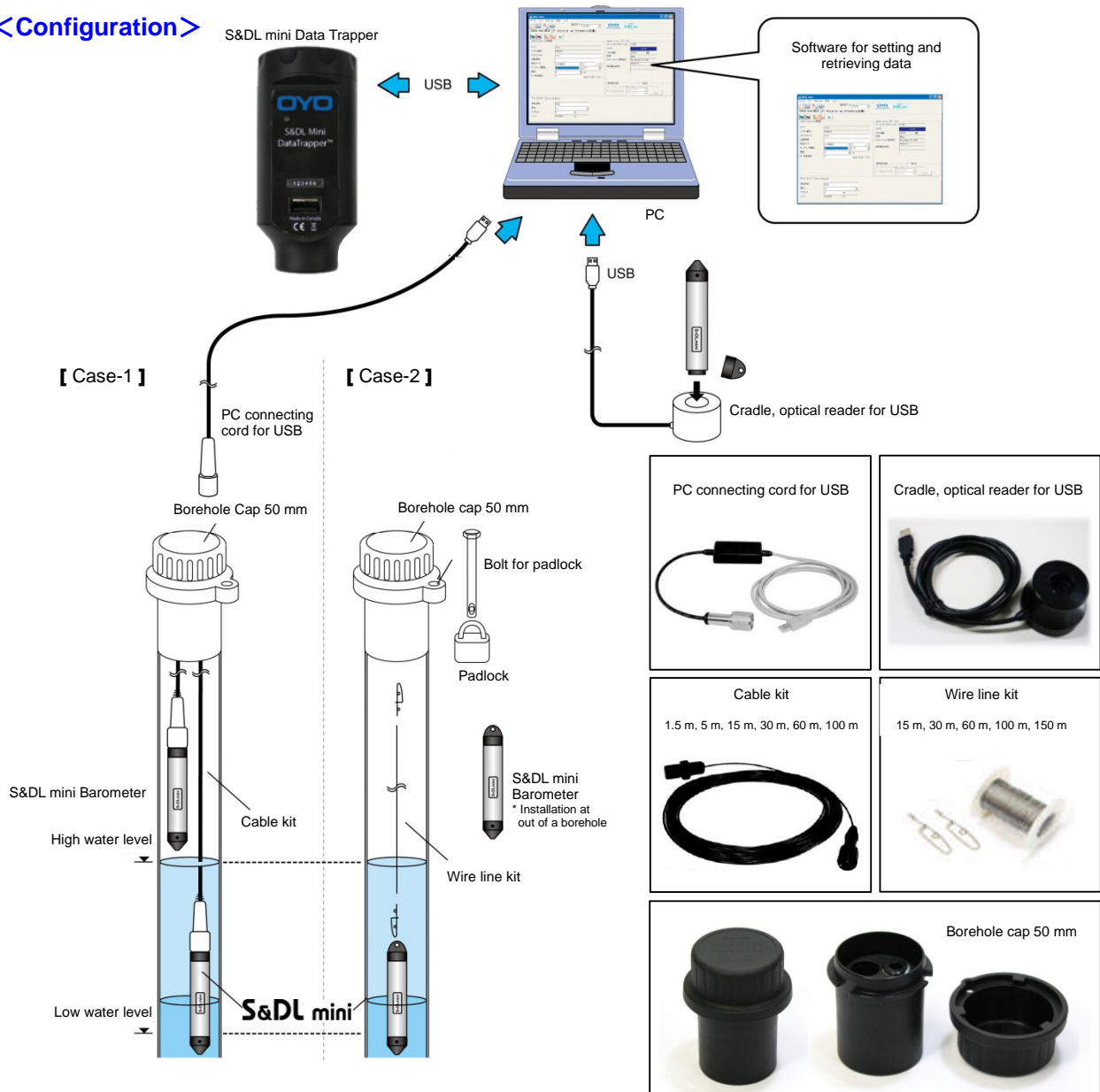

OYO
 oyo corporation



JQA-2772

Please note specifications are subject to change without notice for the improvement.

● Instruments & Solutions Division
 43 Miyukigaoka, Tsukuba, Ibaraki, 305-0841 Japan
 Phone: +81-298-51-5078, Fax: +81-298-51-7290
 e-mail: seihin@oyo.jp

● Head Office
 7 Kanda-Mitoshiro-cho, Chiyoda-Ku, Tokyo 101-8486, JAPAN
 Phone: +81-3-5577-4501, Fax: +81-3-5577-4567

■ Your representative